

MULTI-FIX SERIES

1. GENERAL OVERVIEW

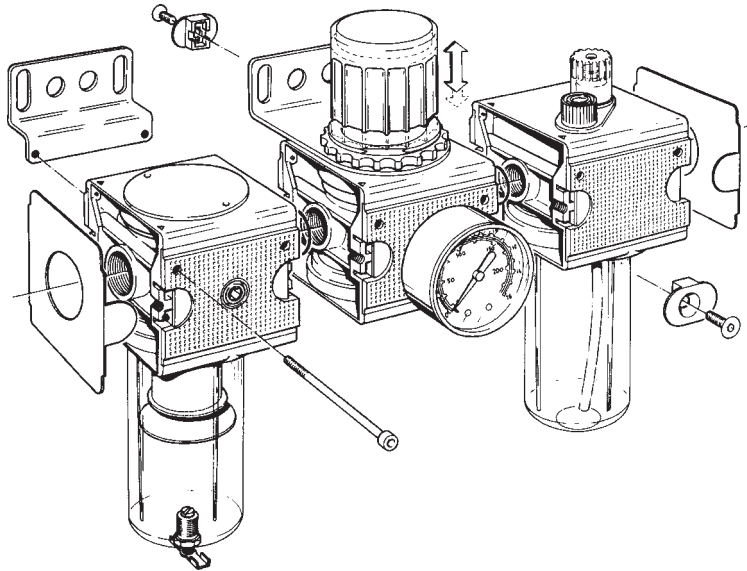

Description

FRL-units purify the air and remove corrosive moisture and abrasive solids from the airstream. They also regulate and reduce main line pressure and provide lubrication for various pneumatic control equipment. (eg. air tools, cylinders and systems)

Installation

By selecting the correct equipment and focus on the correct regulations, improved service life will result in a reduction in downtime of pneumatic systems. These service-units must be mounted vertically and as near as possible to the pneumatic control element or system.

Filter

Compressed air contains moisture and abrasive solids which if left unheaded would have an adverse effect on pneumatic control equipment.

The filter element must be cleaned at regular service intervals to avoid any excessive pressure drop across the unit. It is also recommended to control excess condensate builds up in the filter bowl and switching off, removing and cleaning the bowl or ensuring that the automatic drain is functioning correctly.

Various filter elements can be fitted depending on the particular application or environment. The standard grade of filtration is to 40µm (DIN 4003), however a range of alternatives are also available.

Regulator

The regulator regulates the primary pressure (PE) using a control spring & diaphragm. This keeps the secondary pressure (PA) steady to a required level to operate downstream equipment & tooling.

Lubricator

The lubricator creates an airborne fog or mist that passes downstream to lubricate compressed air equipment & tooling. Most modern pneumatic control equipment is designed to function "lube free" however when using lubrication on air tooling service life is greatly improved.

Oil consumption : +/- 1-2 drops (standard) (at an air flow of $q_v = 1000 \text{ NI/min}$)

It is possible to fill the lubricator units under pressure by means of a vent plug screw. Slowly unscrew the vent plug relieving the bowl pressure and fill the lubricating oil and re-tighten the vent plug screw.

Recommended lubrication : HL 25 DIN 51524 - ISO VG 32

General

Care should be taken when cleaning polycarbonate bowls. Tric based agents such as Benzol, Aceton and all fluids which contain plasticizer should not be used under any circumstances.

Max. working pressure filter & lubricator with polycarbonate bowl : 16 bar / metal bowl : 25 bar

Max. primary pressure (PE) for regulator : 16 bar, Max. temperature : 60°C

HOW TO ORDER COMPLETE FRL UNITS?

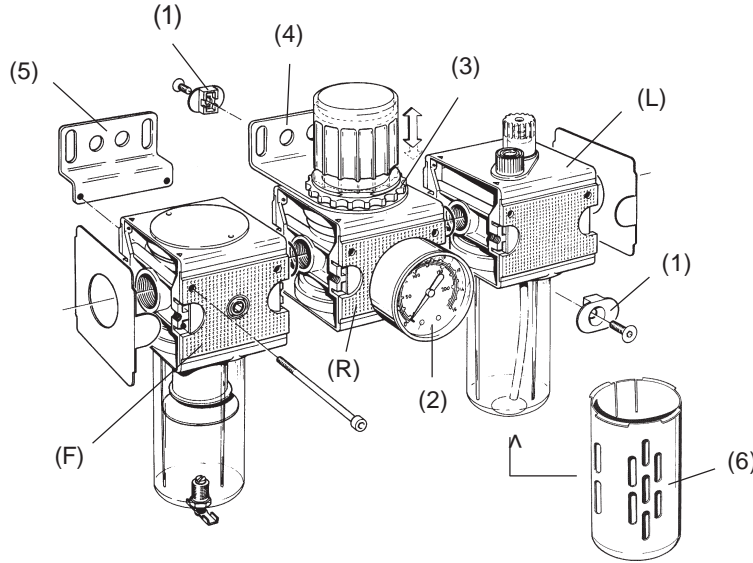

FRL (3 PARTS)



Series	0		1		3		5		
	Type	00	01	11	12	33	34	54	55
Port	1/8"	1/4"	1/4"	3/8"	1/2"	3/4"	3/4"	1"	
Filter (F)	F00HA	F01HA	F11HA	F12HA	F33HA	F34HA	F54HA	F55HA	
Regulator (R)	R00	R01	R11	R12	R33	R34	R54	R55	
Lubricator (L)	L00	L01	L11	L12	L33	L34	L54	L55	
Coupling kit (1)	KP00	KP00	KP11	KP11	KP33	KP33	KP55	KP55	
Gauge (2)	MANO-1/8"	MANO-1/8"	MANO-1/4"	MANO-1/4"	MANO-1/4"	MANO-1/4"	MANO-1/4"	MANO-1/4"	
Panel mount nut (3)	DR0034	DR0034	DR0034	DR0034	C33-42	C33-42	-	-	
Mounting bracket (4)	MW30	MW30	MW30	MW30	MW50	MW50	-	-	
Mounting bracket (5)	-	-	ZW11	ZW11	ZW33	ZW33	ZW55	ZW55	
Bowlguard (6)	-	-	C11-45	C11-45	C33-45	C33-45	C33-45	C33-45	

Grey indicated types = standard port size = delivery from stock

CL (2 PARTS)



Series	0		1		3		5		
	Type	00	01	11	12	33	34	54	55
Port	1/8"	1/4"	1/4"	3/8"	1/2"	3/4"	3/4"	1"	
Filter-regulator (F+R)	C00HA	C01HA	C11HA	C12HA	C33HA	C34HA	C54HA	C55HA	
Lubricator (L)	L00	L01	L11	L12	L33	L34	L54	L55	
Coupling kit (1)	KP00	KP00	KP11	KP11	KP33	KP33	KP55	KP55	
Gauge (2)	MANO-1/8"	MANO-1/8"	MANO-1/4"	MANO-1/4"	MANO-1/4"	MANO-1/4"	MANO-1/4"	MANO-1/4"	
Panel mount nut (3)	DR0034	DR0034	DR0034	DR0034	C33-42	C33-42	-	-	
Mounting bracket (4)	MW30	MW30	MW30	MW30	MW50	MW50	-	-	
Mounting bracket (5)	-	-	ZW11	ZW11	ZW33	ZW33	ZW55	ZW55	
Bowlguard (6)	-	-	C11-45	C11-45	C33-45	C33-45	C33-45	C33-45	

Grey indicated types = standard port size = delivery from stock

C COMPLETE

Code	C01COMPLETE 1/4"	C11COMPLETE 1/4"	C33COMPLETE 1/2"
Parts	C01HA + MANO DR0034 + MW30	C11HA + MANO DR0034 + MW30	C33HA + MANO C33-42 + MW50

Technical modifications keep in reserve !

(2012/07)